

**Manufacturers & Stockists of Nickel Alloy, Titanium Alloys, Special Metals & Stainless Steel Products**

## CROSS

Jade Special Metals is one of the finest distinguished exporters and traders of Equal & Reducing Cross Pipe Fittings, which are essential constituents when it comes to strapping joining. Stainless Steel Equal Cross Pipe Fittings is a cold drawn annealed steel of moderately elevated hardenability by means of its chromium content that offers excellent hardness infiltration, and the molybdenum conveys consistency of hardness and soaring strength. Carbon Steel Reducing Cross Pipe Fittings responds quite well to heat-treatment and is comparatively trouble-free to machine in the annealed situation. Our Super Duplex Steel Equal Cross Pipe Fittings has excellent strength and wear resistance, along with good toughness, joined in the company of good ductility, and has the capability to defy stress at high temperatures.

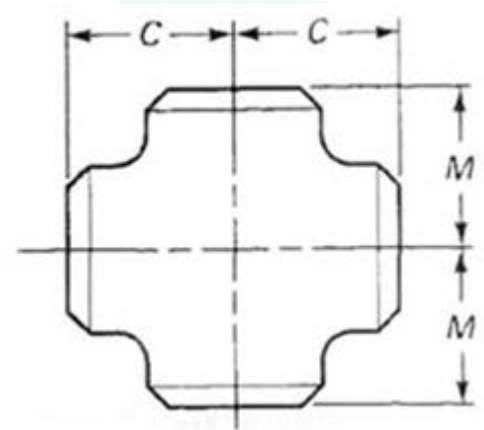

**Standards :** ASME/ANSI B16.9, ASME B16.28, MSS-SP-43, BS4504, BS4504, BS1560, BS10 ASME 16.11, MSS SP-79, 83, 95, 97, BS 3799

**Thickness :** Schedule 5S, 10S, 20S, S10, S20, S30, STD, 40S, S40, S60, XS, 80S, S80, S100, S120, S140, S160, XXS and etc.

**Size :** Seamless Tee ( 1/2" ~ 24"), ERW / Welded / Fabricated Cross (1/2" ~ 48").

**Type :** Seamless / ERW / Welded / Fabricated

**Form :** Equal Cross, Unequal Cross, Reducing Cross, Pipe Cross, Butt weld Cross.

### Cross Material & Grades

#### **Stainless Steel Cross :**

ASTM A403 WP316/316L, ASTM A403 SA / A 774 WP-S, WP-W, WP-WX 304/304L, ASTM A182 F316L, 304L, DIN 1.4301, DIN1.4306, DIN 1.4401, DIN 1.4404

#### **Duplex & Super Duplex Steel Cross :**

ASTM A815, ASME SA 815 UNS NO S31803, S32205. UNS S32750, S32950. Werkstoff No. 1.4462

#### **Carbon Steel Cross :**

ASTM A234, ASME SA234 WPB , WPBW, WPHY 42, WPHY 46, WPHY 52, WPH 60, WPHY 65 & WPHY 70.

**Low Temperature Carbon Steel Cross :** ASTM A420 WPL3, A420 WPL6

**Manufacturers & Stockists of Nickel Alloy, Titanium Alloys, Special Metals & Stainless Steel Products**

**Alloy Steel Cross :**

ASTM / ASME A/SA 234 Gr. WP 1, WP 5, WP 9, WP 11, WP 12, WP 22, WP 91

**Copper Alloy Steel Cross :** ASTM B122, B171, B466, B467, ASTM SB 61 , SB62 , SB151 , SB152 UNS No. C70600 (Cu-Ni 90/10), C 71500 (Cu-Ni 70/30), UNS No. C 10100, 10200, 10300, 10800, 12000, 12200

**Nickel Alloy Buttweld Cross:**

ASTM SB564, SB160, SB472, SB162 Nickel 200 (UNS No. N02200), Nickel 201 (UNS No. N02201), Monel 400 (UNS No. N04400), Monel 500 (UNS No. N05500), Inconel 800 (UNS No. N08800), Inconel 825 (UNS No. N08825), Inconel 600 (UNS No. N06600), Inconel 625 (UNS No. N06625), Inconel 601 (UNS No. N06601), Hastelloy C 276 (UNS No. N10276), Alloy 20 (UNS No. N08020), Titanium (Grade 2 & 5)



We offer wide range of Cross that in compliance with ASTM, ANSI, IS, BS and DIN standards at best Market prices in India. To know more about the latest price of Cross please feel free to contact us on [sales@jadealloys.com](mailto:sales@jadealloys.com) or call us on +91 9987685906